

|                 |           |           |           |
|-----------------|-----------|-----------|-----------|
| PANEL THICKNESS | 1.0-1.6mm | 1.7-2.6mm | 2.7-3.2mm |
| "L" SIZE        | 35.2      | 36.0      | 36.4      |

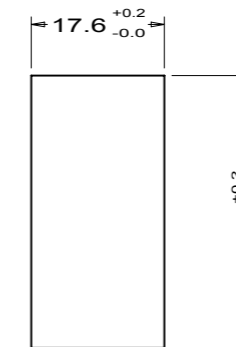

PANEL APERTURE DETAILS

DATA

- 1 - TOLERANCE  $\pm 0.4$ mm UNLESS STATED
- 2 - CASING MATERIAL: POLYAMIDE (V-0 @ 0.8mm)
- 3 - CONFIGURATION: HYDRAULIC MAGNETIC CIRCUIT BREAKER
- 4 - MAXIMUM OPERATING VOLTAGE : 80V DC
- 5 - INTERRUPTING CAPACITY : 0.6kA @ 80V DC
- 6 - OPERATING TEMPERATURE : -40° C TO +85° C
- 7 - APPROVALS : UL489A : VDE(IEC/EN 60934)
- 8 - HANDLE : BLACK (I/O & ON/OFF & AMP RATING)
- 9 - CATALOGUE No : BDH1FD-B0ZXBS-0200X-32  
RE-ORDER No : BDBH0410U  
RATING : 2A
- CATALOGUE No : BDH1FD-B0ZXBS-0600X-32  
RE-ORDER No : BDBH0411U  
RATING : 6A
- CATALOGUE No : BDH1FD-B0ZXBS-1000X-32  
RE-ORDER No : BDBH0412U  
RATING : 10A
- CATALOGUE No : BDH1FD-B0ZXBS-1600X-32  
RE-ORDER No : BDBH0413U  
RATING : 16A
- CATALOGUE No : BDH1FD-B0ZXBS-2000X-32  
RE-ORDER No : BDBH0414U  
RATING : 20A
- CATALOGUE No : BDH1FD-B0ZXBS-2500X-32  
RE-ORDER No : BDBH0415U  
RATING : 25A
- CATALOGUE No : BDH1FD-B0ZXBS-3000X-32  
RE-ORDER No : BDBH0416U  
RATING : 30A
- CATALOGUE No : BDH1FD-B0ZXBS-0400X-32  
RE-ORDER No : BDBH0424U  
RATING : 4A

LOAD

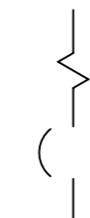

LINE

OFF POSITION

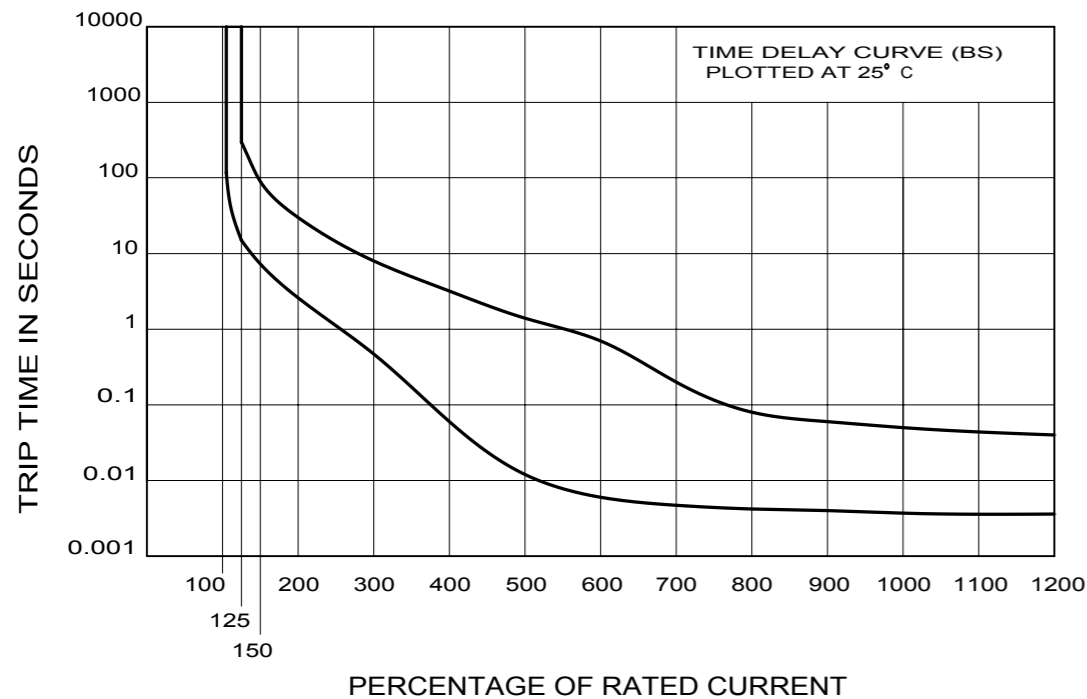

| PERCENTAGE OF RATED CURRENT  | 105%    | 125% | 200% | 400% | 600%  | 800%   | 1200%  |
|------------------------------|---------|------|------|------|-------|--------|--------|
| MINIMUM TRIP TIME IN SECONDS | NO TRIP | 15   | 2.6  | 0.06 | 0.006 | 0.0042 | 0.0036 |
| MAXIMUM TRIP TIME IN SECONDS | NO TRIP | 300  | 30   | 3.2  | 0.7   | 0.08   | 0.04   |

| B   | DCN: 111142<br>BDBH0424U INCLUDED | CB   |
|-----|-----------------------------------|------|
| A   | DCN: 111068<br>FIRST ISSUE        | CB   |
| REV | DESCRIPTION                       | SIGN |

|   |      |
|---|------|
| MATING FACE   | -MF  |
| PROCESS DIMENSION   | -PD  |
| INTERSECTION  | -INT |
| BEFORE PLATING  | -BP  |
| ALL DIMENSIONS IN   | -mm  |
| TOLERANCES ON UN-DIMENSIONED 90° FEATURES ARE $\pm 0.5^\circ$ |      |
| TOLERANCES $< \pm 0.1$ ARE CRITICAL                           |      |
| BRACKETED DIMENSIONS=EXISTING TOOLING                         |      |

|              |     |                 |
|--------------|-----|-----------------|
| SURFACE AREA | N/A | mm <sup>2</sup> |
| VOLUME       | N/A | mm <sup>3</sup> |
| MATERIAL     | N/A |                 |
| RAW MTL No.  | N/A |                 |
| FINISH       | N/A |                 |

|                         |                         |      |            |
|-------------------------|-------------------------|------|------------|
| DRAWN                   | CB                      | DATE | 27/10/2011 |
| CHECK                   | APPD                    |      |            |
| TOLERANCES              | DO NOT SCALE            |      |            |
| X $\pm 0.5$             | ORIGINAL SIZE <b>A3</b> |      |            |
| X.X $\pm 0.1$           |                         |      |            |
| X.XX $\pm 0.05$         |                         |      |            |
| ANGULAR $\pm 0.5^\circ$ |                         |      |            |

TITLE  
B-FRAME DATA SHEET  
SINGLE POLE ROCKER



|          |          |
|----------|----------|
| DRG. No. | 3990A445 |
| UG       |          |

ALL INFORMATION CONTAINED IN THIS DOCUMENT IS THE PROPERTY OF CBI AND IS TO BE TREATED AS CONFIDENTIAL. DISCLOSURE TO THIRD PARTIES IS NOT PERMITTED.